

# Fitting Instructions Up the Rake

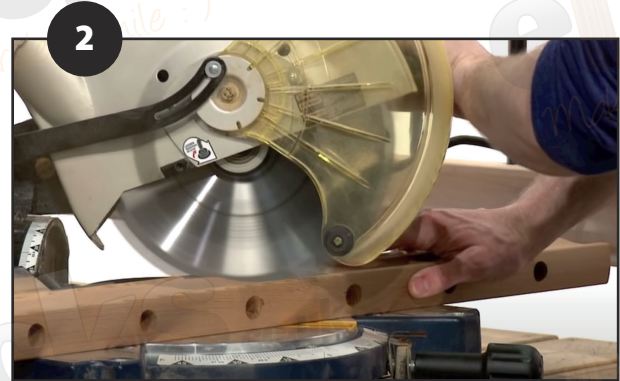

1. With your posts in place simply centre the pre-drilled rail between the two posts, on the edges of the steps. Move the rail until you have an equal distance from the outer hole at each end to the post and mark with a pencil.



2. Transfer the same measurements to the other pre-drilled rail, set your saw to the pencil mark and trim both pre-drilled rails to the inside of the pencil mark on each end to allow for the width of the rail hanger bracket.



3. Attach the rail hanger brackets to the end of the pre-drilled rails.

Then attach the bottom stair rail to the post, attaching the top of the hanger first then the bottom.



4. With the high-quality pink grip adhesive (sold separately), fill each pre-drilled hole about half way full. Then insert the angle adapters into the pre-drilled holes.

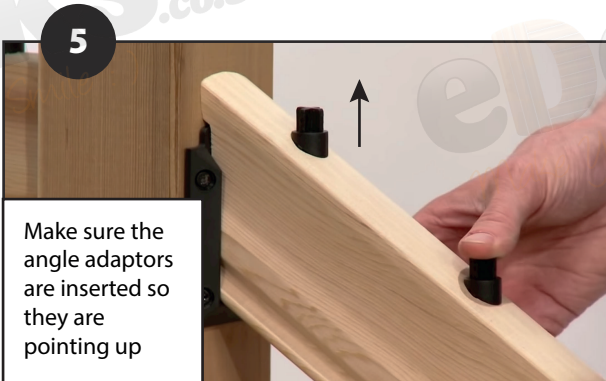

Make sure the angle adaptors are inserted so they are pointing up

5. The angle adaptors on the bottom rail must be inserted with the angle to the top of the stairs.

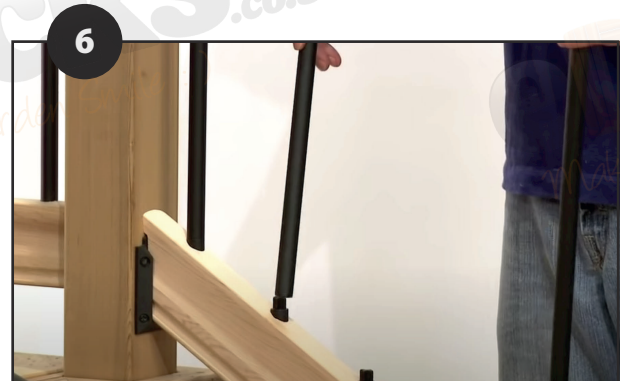

6. The traditional balusters fit over the angle adaptors, place all balusters on the adaptors.

# Fitting Instructions Up the Rake

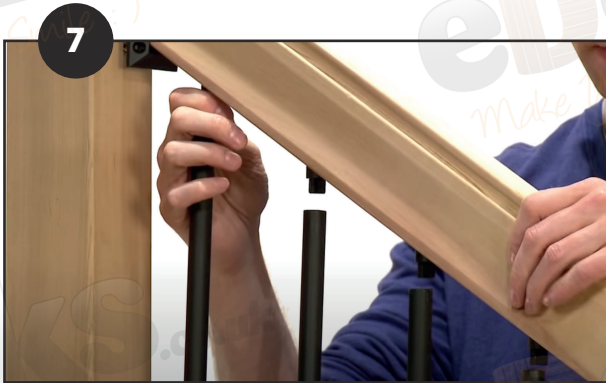

7. Then starting at one end line up the balusters with the angle adaptors in the top pre-drilled rail, moving across the length and pushing the top rail down.



8. Now affix the top rail hanger brackets at each end to the posts, like you did for the bottom rail in step 3.



9. If adding the optional cap rail place over the edge of the stairs and mark the same as the pre-drilled rails in step 1, cut the cap rail along the marked line, apply the high-quality pink grip adhesive (sold separately) into the groove of the cap rail.



10. Fix the cap rail in place then clamp until the adhesive sets

